

pool cover
guillotine windows/doors
telescopic sky roof
glide in retracted roof
leaning on structures
wind breaks
bi-fold doors
green house
stand alone structures



SkyTech

Breath of fresh air in kinetic architecture

Product Data Sheet 2

what is a SkyTech guillotine system?

Borders, no more!

A SkyTech guillotine system is an automated window or door which is operated in a vertical telescopic movement to be folded in itself once opened. In the open position retracted frames could accumulate on top or on bottom according to the choice for the system to be a door or a window.

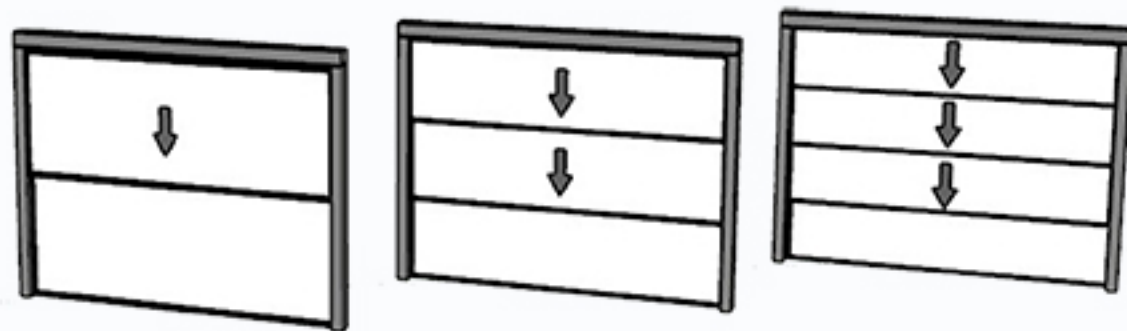

guillotine window

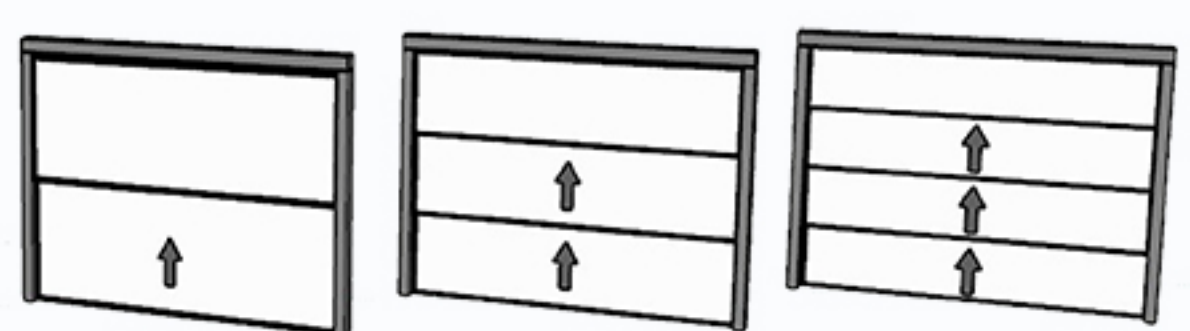

guillotine door



what provides a SkyTech guillotine window or door

a widened perspective

Counter to the conventional door/window systems the spatial orientation of the system is horizontal which benefits to the user to maximize the view with a widened perception. The anatomy of the system which incloses the movement within the lateral cases allows the user to utilize the space that surrounds the frame. As a result, when in open position, the window system serves a glass balustrade which grants a separation between inside and outside and further more a security border on higher levels.

how is it secure against falling?

Safety is our priority!

Locomotive frame of a SkyTech guillotine system is carried by the polyamid nut of the screw drive shaft which is connected to the motor on top. All driving mechanism is supported by the aluminium cases which are mounted onto the load bearer structure of the building. Once the motor starts running, the shafts on both sides turn, pushing the polyamid nuts vertically which hold the glass frame. This is basically a metal skeleton where each member supports the next one from the bottom to the top at all times and nothing is hanging loose. Thus the system grants security against falling in parking position and in motion.

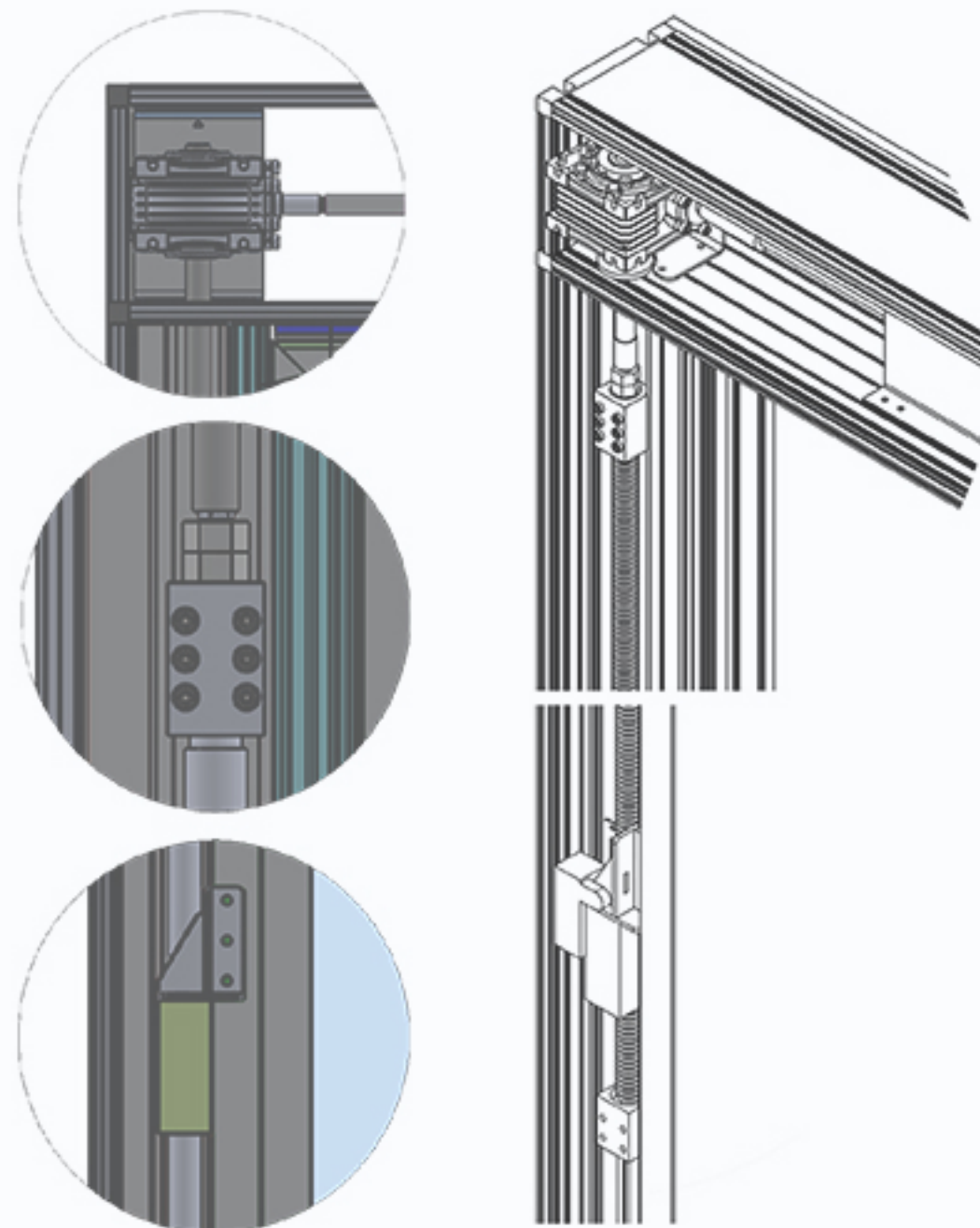

how is it entegrated into your wall or façade?

we don't compromise on comfort

SkyTech's design answers the question of aesthetics with thin aluminium cases and frames coated with powder coatings, concealing the mechanical drive or thermal breaks. The thermal insulation is maximized in cases, motor box and frames via polyurethane thermal breaks on material scale and via polyamid tongue and groove profiles between the frames on on elemental scale as never seen in their likes. With upgraded load lifting capacity, the system permits numerous insulated glass variations. Also the glazing method where the glass is embeded inside the frame, covers the requirement of protection against the burglary.

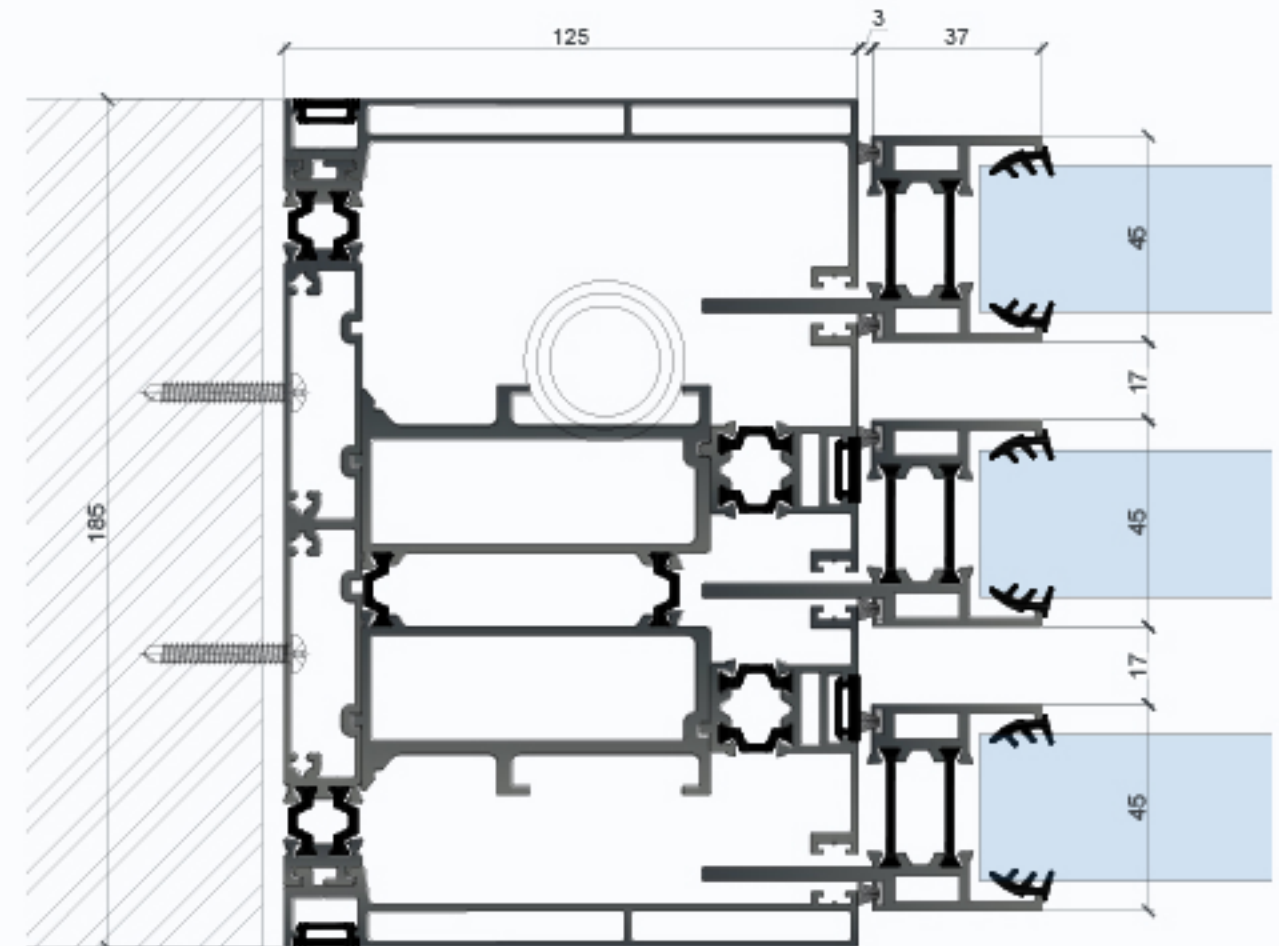

Statical Features

width: 1250-5500 mm

height: 1000-5500 mm

support profiles: 1 wind support profile per frame after 2 m of width

Physical Features

motor box size: 185x185 mm

lateral case size: 185x125 mm

frame width: 40 mm

Configuration and Movement

frame quantity: 1-4 frames

system type: door or window

movement: telescopic retraction, parking on top or parking on the bottom

Motor and Electricity

motor: 0,55 kW industrial motor, gear and screw drive

weight: max 800 kg

electric feed "World": 220V 1 phase / 380V 3 phase 50-60Hz

electric feed "USA": 110V 2 phase 50-60Hz

control system: remote control / wall button / central automation / mobile application

safety photocells: single pair sensor / linear photocell

Insulation

Aluminium body: 100% thermally broken

glass thickness: 12-37 mm, insulated glass is available

min. Uw value: 1.0 W/m²K

watertightness class 8A (at 600 Pa)

air permeability EN 12207 class 2 (at +660 Pa); Class (at-660 Pa)

Material

Aluminium body: 6063-T6 Aluminium alloy

surface finish: electrostatic powder coating, anodization, pre-treatment,
seaside application

gaskets: EPDM

mechatronic main parts: chromated steel

mechatronic connection parts: polyamid / kestantid

fasteners: galvanized steel

Assembly

structural connection: screwed twice, each 50 cm on sides and top

installation tolerance: shim support up to 5 mm tolerance

frame assembly: 45 corner press assembly

glass assembly: non-structural glazing, slide-in assembly

Extra Features

cleaning: Easy cleaning frame available on the bottom